

SCORE contracting forces:

General Contractor: Lydig Construction
 Detention Equipment Contractor (DEC): CML Specialties
 Prefabricated Cells: Trussbilt
 Security Systems Integrator (SSI): Sierra Detention Systems
 Precast Components Supply: Bethlehem Construction

Precast Components Erection: Precision Precast Erectors
 Steel Roof Joists: Powers Steel Group
 Mechanical Subcontractor: Delta Technologies
 Plumbing Subcontractor: Robison Mechanical
 Electrical Subcontractor: Berg Electric

SCORE Jail
 South Correctional Entity
 Des Moines, Washington

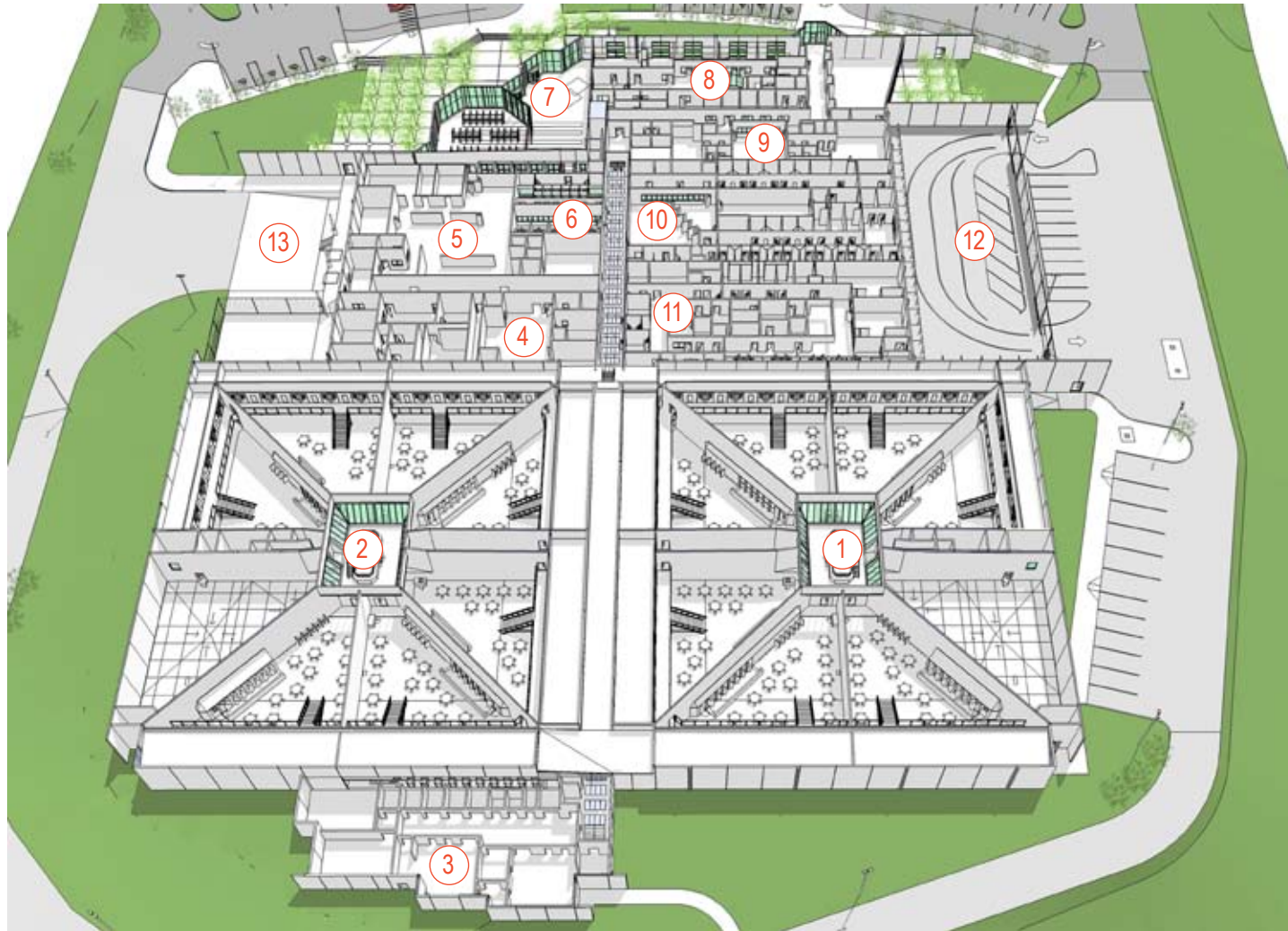

Plan Legend

- | | | |
|---|---------------------------|-------------------------------|
| 1. Housing Unit A Control | 5. Food Service | 9. Staff Support |
| 2. Housing Unit B Control | 6. Video Arraignment | 10. Booking & Release |
| 3. Programs (religion, education, etc.) | 7. Lobby & Video Visiting | 11. Health Services |
| 4. Laundry & Maintenance | 8. Administration | 12. Booking/Intake Sally Port |
| | | 13. Loading Dock/Receiving |

Lydig Construction expedites the work.

- Fully erected 7 months from contract signing.
- All precast concrete enclosure walls in place.
- Site grading complete.
- All power, telephone, and data trunk lines installed.
- Facility roofed.
- Average of 80 workers on-site in July.



Serving the cities of Auburn, Burien, Des Moines, Federal Way, Renton, SeaTac, Tukwila



DLR Group

Architecture Engineering Planning Interiors

901 Fifth Avenue, Suite 700
 Seattle, WA 98164
 206/461-6000



Factory prefabricated cell modules increase security and sound isolation.

CML Specialties is installing steel cell modules prefabricated by Trussbilt in an ISO-9000 rated factory. Pictured is the on-site chase mock-up constructed for SCORE approval. The cell wall construction comprises steel skinned panels filled with concrete. Sound isolation and the security test value of this type of detention construction exceeds that of precast concrete test values. Trussbilt is also factory prefabricating all cell furniture and cell camera housings. Cell surfaces are being painted with an anti-microbial coating.

Plumbing chase layout design provides ease of maintenance.

The plumbing chases are configured to provide accessibility. Access doors are full height. Vent and waste risers are held back from the door openings. The water closet valve is positioned in front of the waste piping. The mezzanine work platform is the full width of the access door and has an OSHA toe kick curb. The supply and return air ducts are prefabricated as an integral part of the chase enclosure. GPS telemetry has been employed to precisely locate utility outlets in the chase floor.



Prefabricated Cell Assembly



SCORE management team selects final colors and materials

SCORE Director Penny Bartley (2nd from the right) reviews final color and material submittals in the SCORE construction trailer. SCORE's construction team includes Construction Manager SOJ, Special Inspections Mayes Testing, and DLR Group architecture, engineering, planning and interiors.

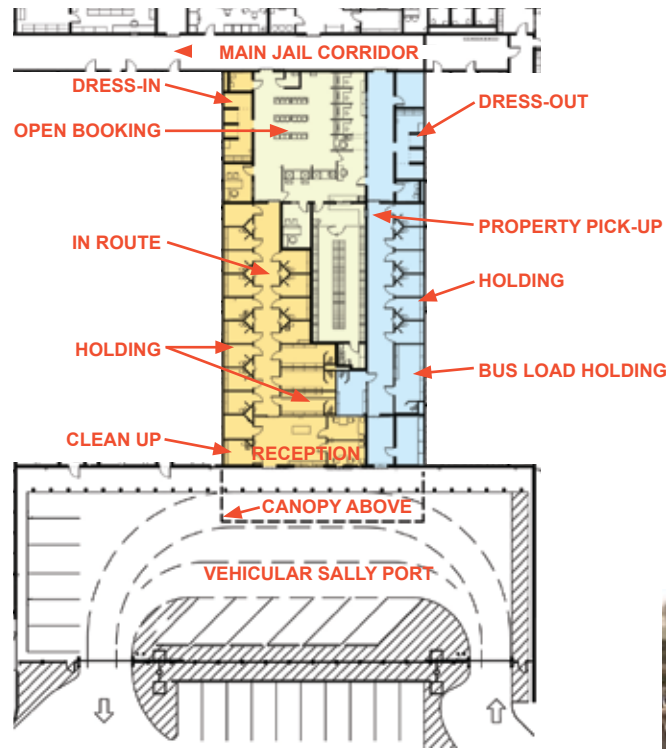

High volume booking department planning improves smooth and safe operations.

The SCORE facility has three unusual planning features to achieve smooth and safe operations:

1. The intake traffic and the outgoing traffic have separated circulation paths and separate holding areas to avoid mixing and to improve security.
2. Substantial holding capacity is provided in booking to avoid the staffing requirements to classify and move offenders into the jail during off hours and allow classification procedures to be followed prior to admittance to the housing units.
3. A large vehicular sally yard accommodates short-term parking, booking traffic, and bus access. The access gates are managed by central control



Vehicular Sally Port Canopy at Intake



Construction staging accelerates the schedule. Interior floors, wall construction and ductwork are well underway.

Lydig Construction is 'cycling' the construction work so that while the roof is still under construction in some areas, other areas are more advanced with interior systems already installed. This method allows each trade to move through the various zones in a sequential manner. These staging techniques allow expedited construction to be achieved without sacrificing the high quality of construction.



Prefabricated Conduit Arrays

Berg Electric factory prefabricated the areas of intense conduit concentrations and brought these arrays to the site on unistrut frames to hold them in place for accurate floor casting.



Conduit Highways

Power and communications conduit is routed below the floor slab to simplify overhead construction.

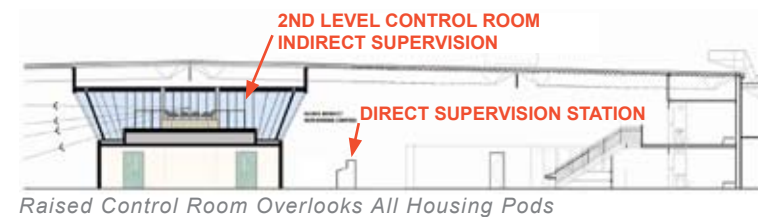

Raised Control Room Overlooks All Housing Pods



Planning and design enable combined direct & indirect supervision.

The SCORE facility is planned for both staff safety and variable staffing modes throughout the day to reflect offender activity periods:

1. The 2nd level control room provides 24/7 indirect supervision with direct line-of-sight into all dayrooms.
2. The 2nd level control room is in constant visual contact with staff in the dayrooms during direct supervision periods, a staff safety feature.
3. Two raised control rooms are provided in the SCORE facility for security redundancy purposes.